

42863 台中市大雅區龍善三街37號
No.37, Longshan 3rd St., Daya Dist., Taichung City 428, Taiwan (R.O.C.)



TEL: +886-4-2565 4729 FAX: +886-4-2560 4348
For English Service : +886-4-2565 0418



E-mail: pone.mt@msa.hinet.net poneltd@gmail.com
Website: www.p-one.com.tw

立式加工中心機
Vertical machining center



Best choice
P-ONE

Professional > Innovation > Insistency

VMC-860S

X & Y 軸線軌，Z軸硬軌機構

X、Y Axes Linear Guide & Z Axes Box Way Mechanism

- ▶ 寬闊的底座為四滑軌，八個滑塊平均點支撐，確保最佳剛性、精度持久性。
 - ▶ Z軸採用方形滑軌，大幅度提升穩定性與抗震性。
 - ▶ X、Y軸採用精密超重負荷型線性滑軌，確保定位精度、加工誤差的控制。
 - ▶ 機台尺寸精巧設計，充分提高機械空間及效能比。
-
- ▶ To ensure the optimum rigidity and durability of the machine, the broad four slide base evenly supported the eight blocks.
 - ▶ Z axes box way design uprates stability and anti-rumble.
 - ▶ To ensure the positioning accuracy and the control of the machining error, X-Y axes adopt precision heavy load linear slide.
 - ▶ Elaborate and small machine provide great efficiency of the space.



▶ 機械外觀尺寸圖 Machine Overall Dimension

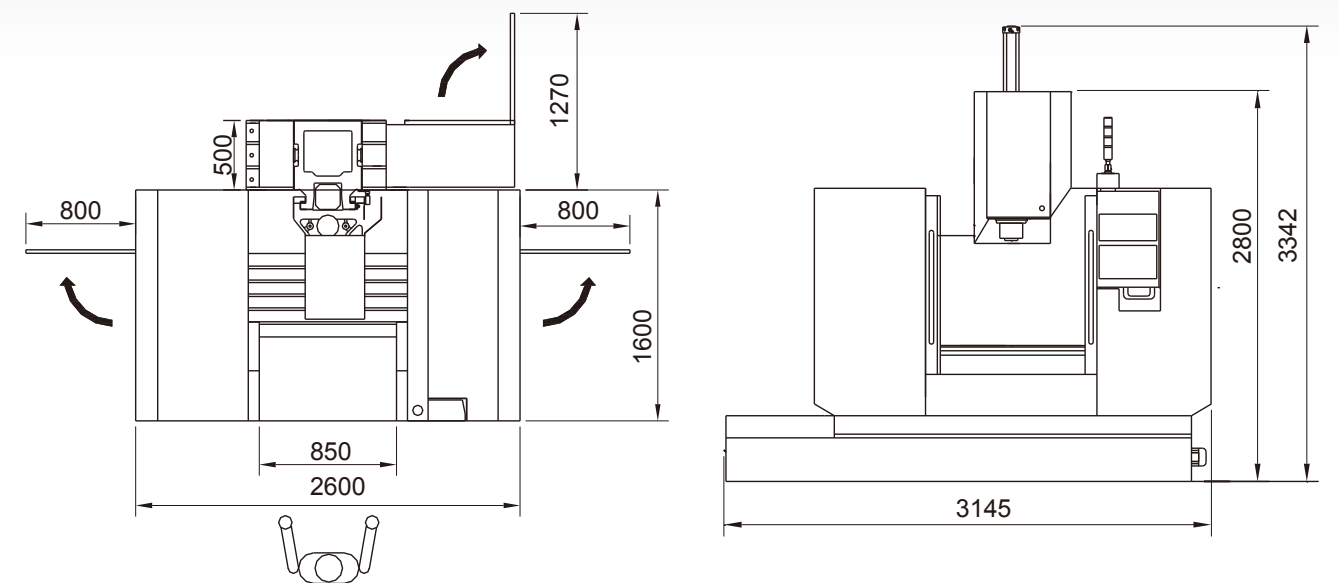



Best choice
P-ONE

Professional > Innovation > Insistency

VMC-1060S

X & Y 軸線軌，Z軸硬軌機構

X、Y Axes Linear Guide & Z axes Box Way Mechanism

- ▶ 寬闊的底座為四滑軌，八個滑塊平均點支撐，確保最佳剛性、精度持久性。
- ▶ Z軸採方形滑軌，大幅度提升穩定性與抗震性。
- ▶ X、Y軸採精密超重負荷型線性滑軌，確保定位精度、加工誤差的控制。
- ▶ 跨距與行程皆以最佳黃金比例設計主軸頭部與Y軸行程的完美搭配，提供機器穩固的支撐，機身以Y型超大接觸底座結合剛性特性，絕不變形。
- ▶ To ensure the optimum rigidity and durability of the machine, the broad four slides base evenly supported the eight blocks.
- ▶ Z axes box way design enhances stability and anti-rumble.
- ▶ To ensure the positioning accuracy and the control of the machining error, X-Y axes adopt precision heavy load linear slide.
- ▶ Golden ratio of headstock and Y axes stroke offers rock-steady support. Ultra large Y-shaped column surface combined with four slides base to minimize deformation during processing.



▶ 機械外觀尺寸圖 Machine Overall Dimension

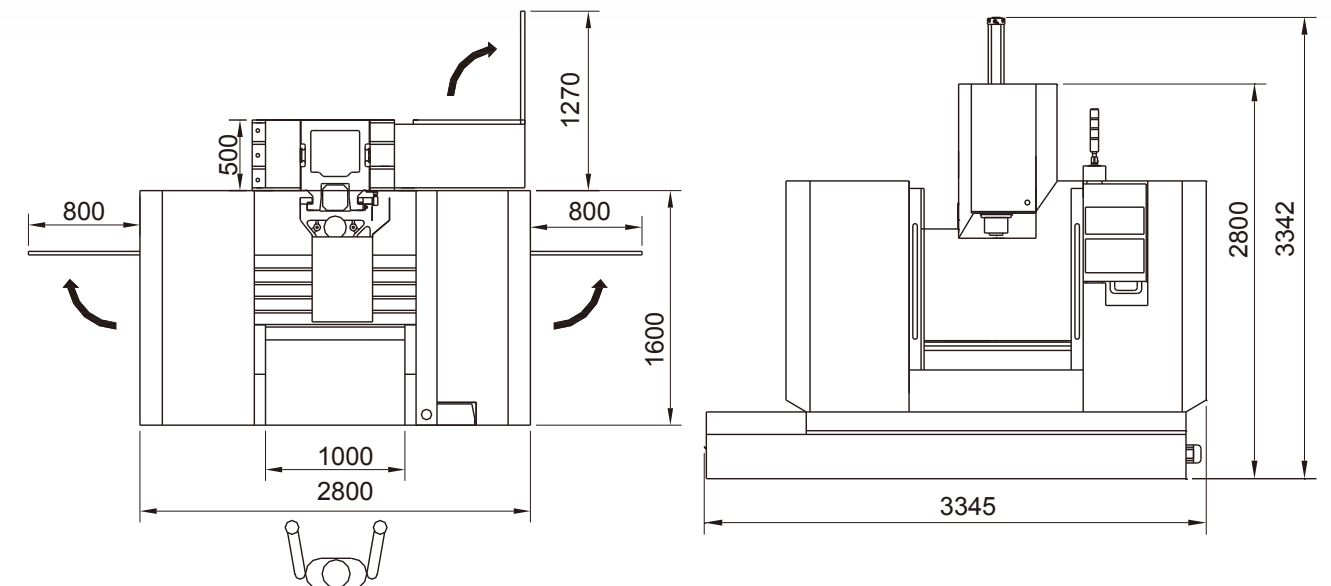



Best choice
P-ONE

► Professional ► Innovation ► Insistency

VMC-1360S

X & Y 軸線軌，Z軸硬軌機構

X、Y Axes Linear Guide & Z axes Box Way Mechanism

- ▶ 寬闊的底座為四滑軌，八個滑塊平均點支撐，確保最佳剛性、精度持久性。
- ▶ Z軸採方形滑軌，大幅度提升穩定性與抗震性。
- ▶ X、Y軸採精密超重負荷型線性滑軌，確保定位精度、加工誤差的控制。
- ▶ 跨距與行程皆以最佳黃金比例設計主軸頭部與Y軸行程的完美搭配，提供機器穩固的支撐，機身以Y型超大接觸底座結合剛性特性，絕不變形。
- ▶ To ensure the optimum rigidity and durability of the machine, the broad four slides base evenly supported the eight blocks.
- ▶ Z axes box way design enhances stability and anti-rumble.
- ▶ To ensure the positioning accuracy and the control of the machining error, X-Y axes adopt precision heavy load linear slide.
- ▶ Golden ratio of headstock and Y axes stroke offers rock-steady support. Ultra large Y-shaped column surface combined with four slides base to minimize deformation during processing.

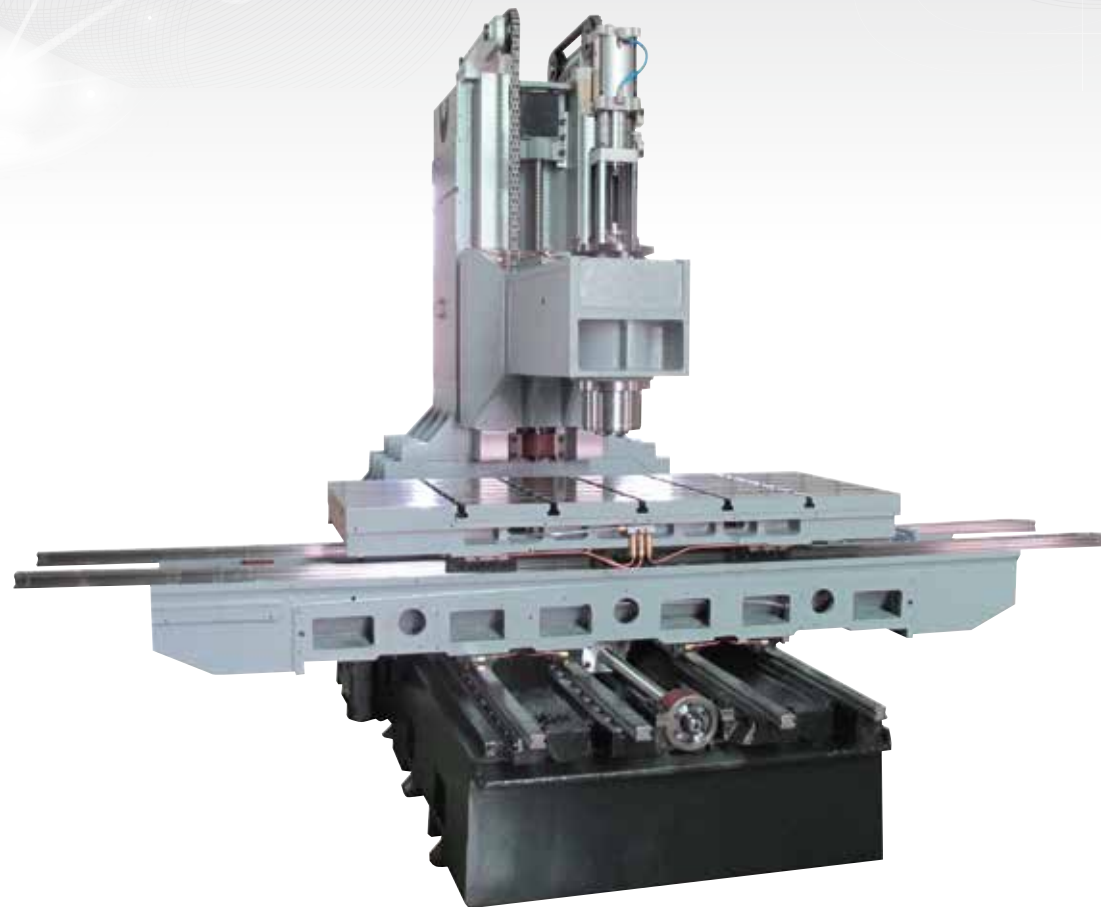

▶ 機械外觀尺寸圖 Machine Overall Dimension

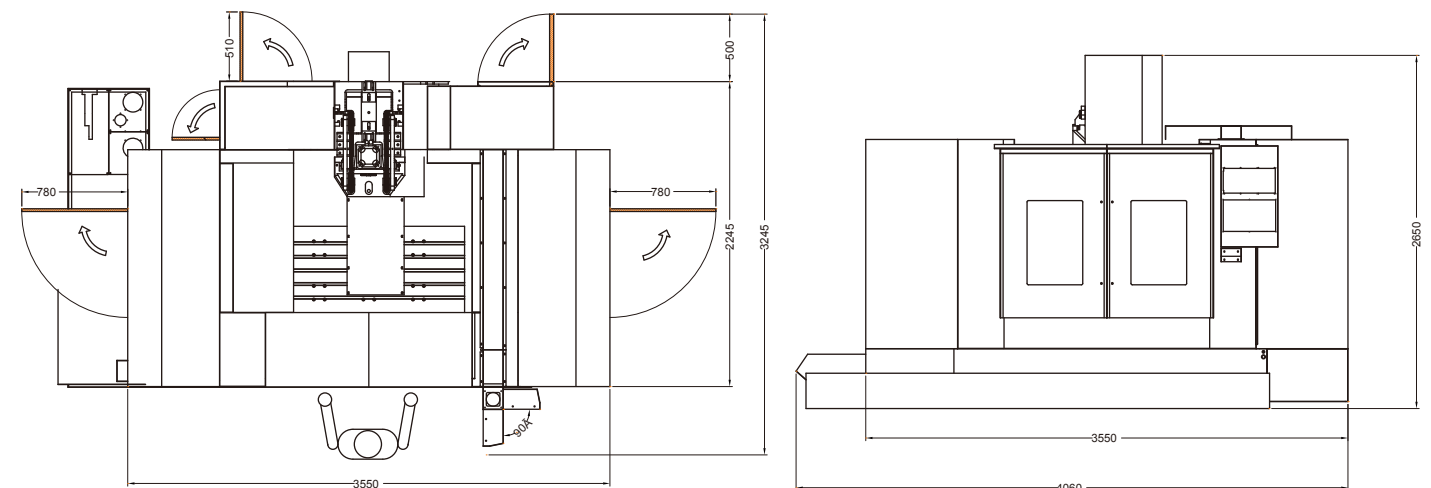



Best choice
P-ONE

> Professional > Innovation > Insistency

VMC-1560S

X & Y 軸線軌，Z軸硬軌機構

X、Y Axes Linear Guide & Z axes Box Way Mechanism

- ▶ 寬闊的底座為四滑軌，八個滑塊平均點支撐，確保最佳剛性、精度持久性。
- ▶ Z軸採方形滑軌，大幅度提升穩定性與抗震性。
- ▶ X、Y軸採精密超重負荷型線性滑軌，確保定位精度、加工誤差的控制。
- ▶ 跨距與行程皆以最佳黃金比例設計主軸頭部與Y軸行程的完美搭配，提供機器穩固的支撐，機身以Y型超大接觸底座結合剛性特性，絕不變形。
- ▶ To ensure the optimum rigidity and durability of the machine, the broad four slides base evenly supported the eight blocks.
- ▶ Z axes box way design enhances stability and anti-rumble.
- ▶ To ensure the positioning accuracy and the control of the machining error, X-Y axes adopt precision heavy load linear slide.
- ▶ Golden ratio of headstock and Y axes stroke offers rock-steady support. Ultra large Y-shaped column surface combined with four slides base to minimize deformation during processing.



▶ 機械外觀尺寸圖 Machine Overall Dimension

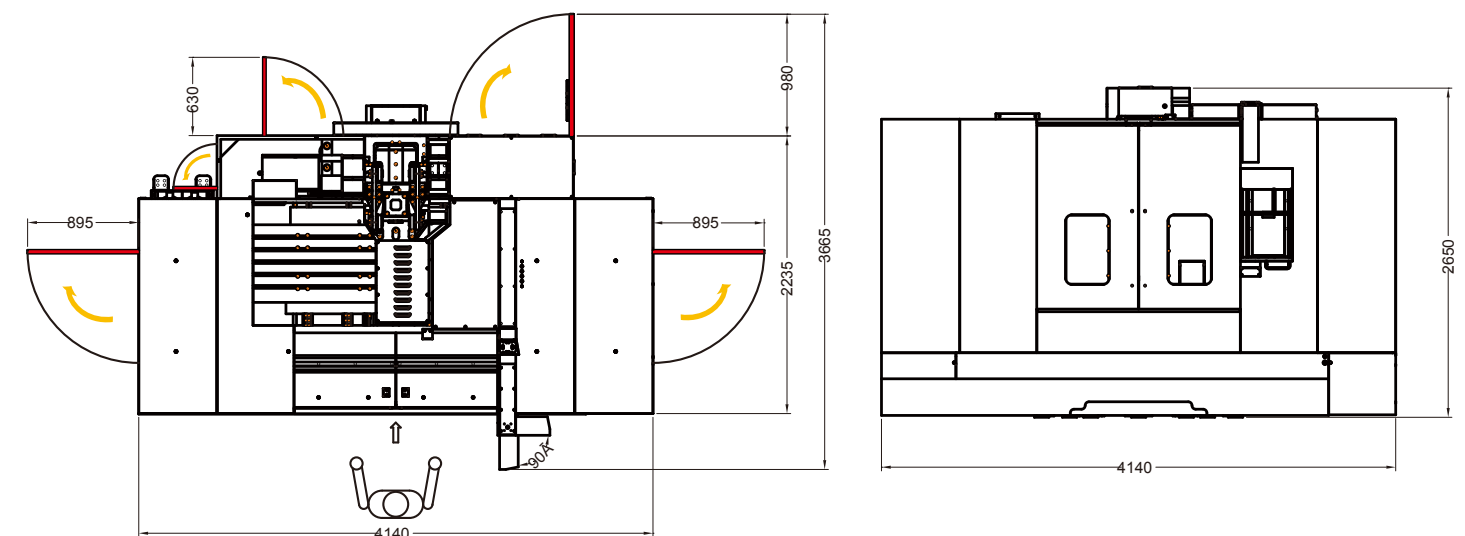



機型	MODEL	VMC-860S	VMC-1060S
X軸行程	X-axis Travel	860mm	1020mm
Y軸行程	Y-axis Travel	580mm	600mm
Z軸行程	Z-axis Travel	580mm	600mm
工作台尺寸	Table Size	950x600mm	1100x600mm
T型槽(寬*個*距)	T-Slots	18x5x100mm	18x5x100mm
工作台最大荷重	Max. Table Load	700kg	800kg
主軸鼻端至工作台距離	Spindle nose to table	90~670mm	100~690mm
主軸中心至立柱距離	Spindle center to column	650mm	650mm
主軸 SPINDLE			
主軸轉速	Spindle Speed	8000rpm 10000rpm & 12000rpm (opt.)	8000rpm 10000rpm & 12000rpm (opt.)
主軸錐度	Spindle Taper	BT-40	BT-40
進給速率 FEEDRATE			
快速位移(X,Y軸)	Rapid Traverse(X,Y)	24m/min	24m/min
快速位移(Z軸)	Rapid Traverse(Z)	18m/min	18m/min/
進給速率(X,Y,Z)	Feed Rate (X,Y,Z)	1-6000mm/min	1-6000mm/min
自動換刀系統 AUTO TOOL CHANGER			
刀具數	Magazine Capacity	24	24
換刀方式	Tool Change Type	Arm type	Arm type
最大刀徑	Max. tool change diameter	Ø75mm	Ø75mm
最大刀具重量	Max. tool weight	7kg	7kg
馬達 MOTOR			
主軸馬達(連續/30分鐘)	Spindle Motor(cont/30min)	AC 7.5/11kw	11/15kw (B12)
軸向馬達	Axise Servo motor	Mitsubishi 3.0kw Fanuc 2.5kw	Mitsubishi 3.0kw Fanuc 2.5kw
機台淨重	Machine N.W.	5800kg	6250kg

機型	MODEL	VMC-1360S	VMC-1560S
X軸行程	X axes travel	1300mm	1500mm
Y軸行程	Y axes travel	680mm	680mm/750mm (Opt.)
Z軸行程	Z axes travel	650mm	650mm/800mm&1200mm(Opt.)
工作台尺寸	Table size	1410x650mm	1700x650mm
T型槽(寬*個*距)	T-slot	18x5x100mm	18x5x100mm
工作台最大荷重	Max. table load	1200kg	1100kg
主軸鼻端至工作台距離	Spindle nose to table	90~740mm	100~750mm
主軸中心至立柱距離	Spindle center to column	750mm	750mm
主軸 SPINDLE			
主軸轉速	Spindle speed	8000rpm 10000rpm & 12000rpm (Opt.)	8000rpm 10000rpm&12000rpm (Opt.)
主軸錐度	Spindle taper	BT-40/ *BT-50(Opt.)	BT40 / *BT50(Opt.)
進給速率 FEEDRATE			
快速位移(X,Y軸)	Rapid Traverse(X,Y)	20m/min	20m/min
快速位移(Z軸)	Rapid Traverse(Z)	18m/min	18m/min
進給速率(X,Y,Z)	Feed Rate(X,Y,Z)	1-6000mm/min	1-6000mm/min
自動換刀系統 AUTO TOOL CHANGER			
刀具數	Magazine Capacity	24	24
換刀方式	Tool change type	Arm type	Arm type
最大刀徑	Max. tool change diameter	Ø75mm	Ø80mm
最大刀具重量	Max. tool weight	7kg	7kg
馬達 MOTOR			
主軸馬達(連續/30分鐘)	Spindle motor(cont/30min)	AC 11/15KW	11/15kw
軸向馬達	Axise servo motor	Mitsubishi 3.0kw Fanuc 3.0kw	Fanuc 3.0kw Mitsubishi 3.5kw
機器淨重	Machine N.W.	7300KG	



Best choice
P-ONE

► Professional ► Innovation ► Insistency

VMC-850A

三軸硬軌機構 X,Y,Z Axes Box way Mechanism

- ▶ 機體皆採用堅固的箱型結構，先進的米漢那鑄鐵材質，經弛力回火處理，結構強、剛性高、不易變形。
- ▶ 底座滑軌採四軌支撐設計，主軌跨距加大，滑動時比一般兩軌更平穩順暢。
- ▶ Box-shape construction and Meehanite cast iron.
- ▶ High rigidity of the machine and deformation resistance through stress relief tempering.
- ▶ 4-slide base with large span design of the main slide and perform high movement stability.

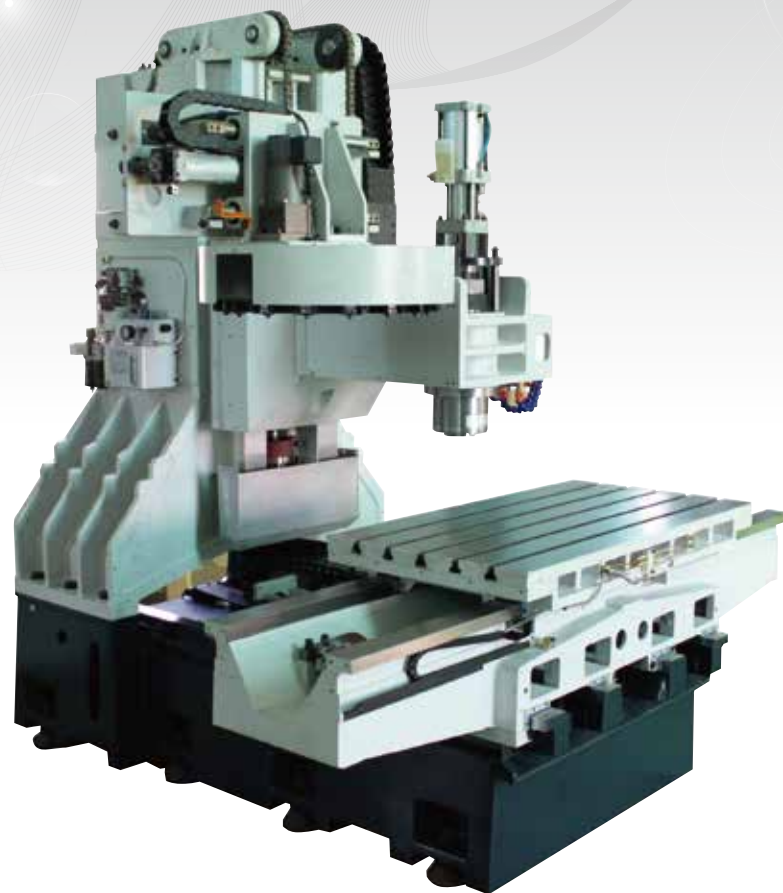

▶ 機械外觀尺寸圖 Machine Overall Dimension

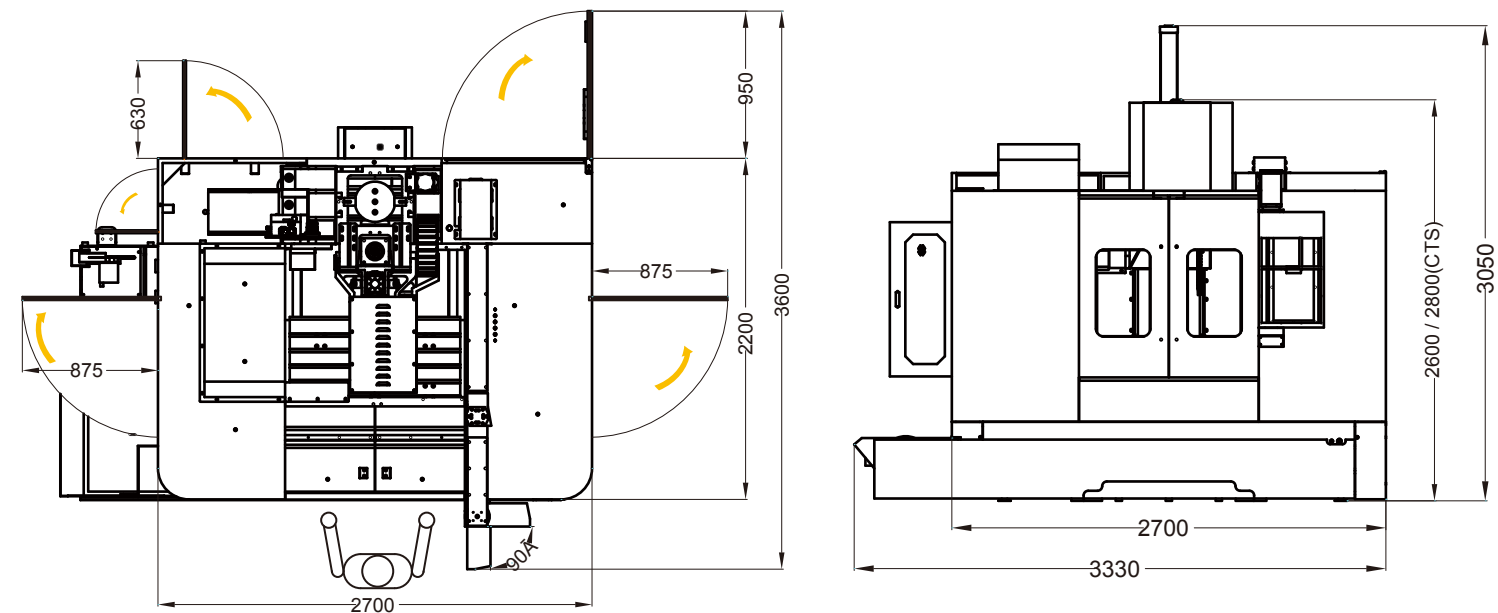



Best choice
P-ONE

> Professional > Innovation > Insistency

VMC-1000

三軸硬軌機構 X,Y,Z Axes Box way Mechanism

- ▶ 機身以Y型超大接觸面與底座結合配置寬闊滑軌，保證剛性高、定位佳，更符合多數模具生產規劃利用。
- ▶ 堅固之本體結構實現絕佳的精度及穩定性。
- ▶ 以有限元素分析法(FEM)分析同負載作用下變形量，針對不足處加以補強以強化整體剛性及穩定性。
- ▶ Ultra large Y-shaped column combined with broad slide base to ensure the high rigidity and positioning accuracy.
- ▶ It's specially designed for various mold & die applications.
- ▶ The body structure offers the best precision and stability.
- ▶ By FEM analysis the structural deformation of the body through various loading.
- ▶ Reinforced & strengthen the overall rigidity and stability of the machine under the intensive loading of heavy-duty cutting.



▶ 機械外觀尺寸圖 Machine Overall Dimension

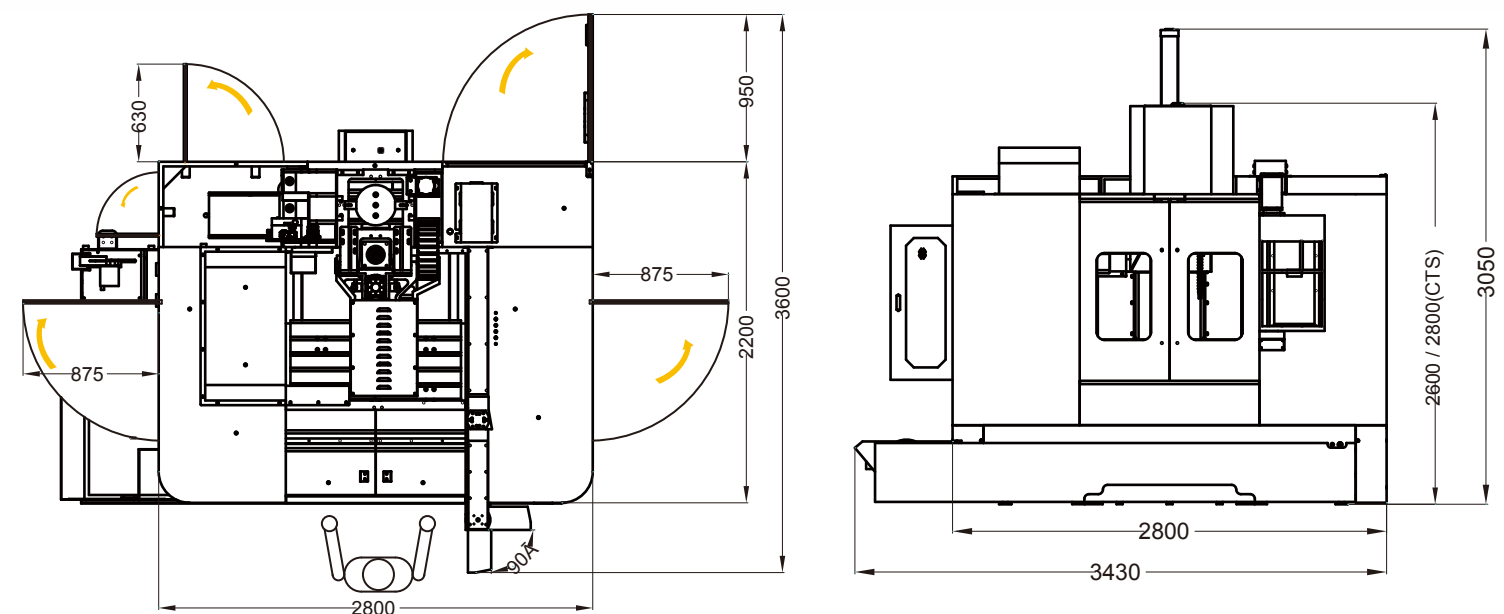



Best choice
P-ONE

► Professional ► Innovation ► Insistency

VMC-1300

三軸硬軌機構 X,Y,Z Axes Box way Mechanism

- ▶ 三軌鑄件數位化設計與剛性分析。
 - ▶ 整體重型結構—高剛性！
 - ▶ 機身、底座、工作台、鞍座為高剛性結構設計。採高級鑄鐵鑄造，經應力消除，確保機台精度穩定。
 - ▶ 工作台與鞍座行程支撐，確保加工物件之穩定性與加工剛性。
-
- ▶ 3- axes casting structure design with rigidity analysis.
 - ▶ Heavy duty structure & high rigidity.
 - ▶ To ensure the accuracy and stability of the machine, the column, base, table and saddle are all made of high quality Meehanite cast iron through stress relief.
 - ▶ Table and saddle are completely supported to assure the stability and rigidity during processing.

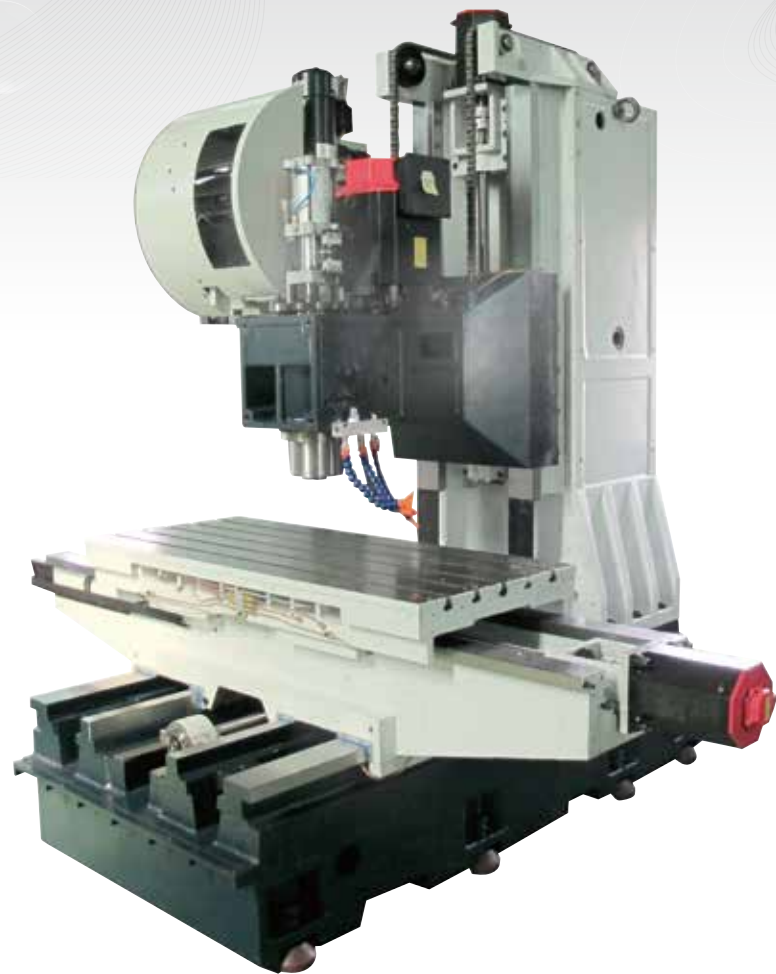

▶ 機械外觀尺寸圖 Machine Overall Dimension

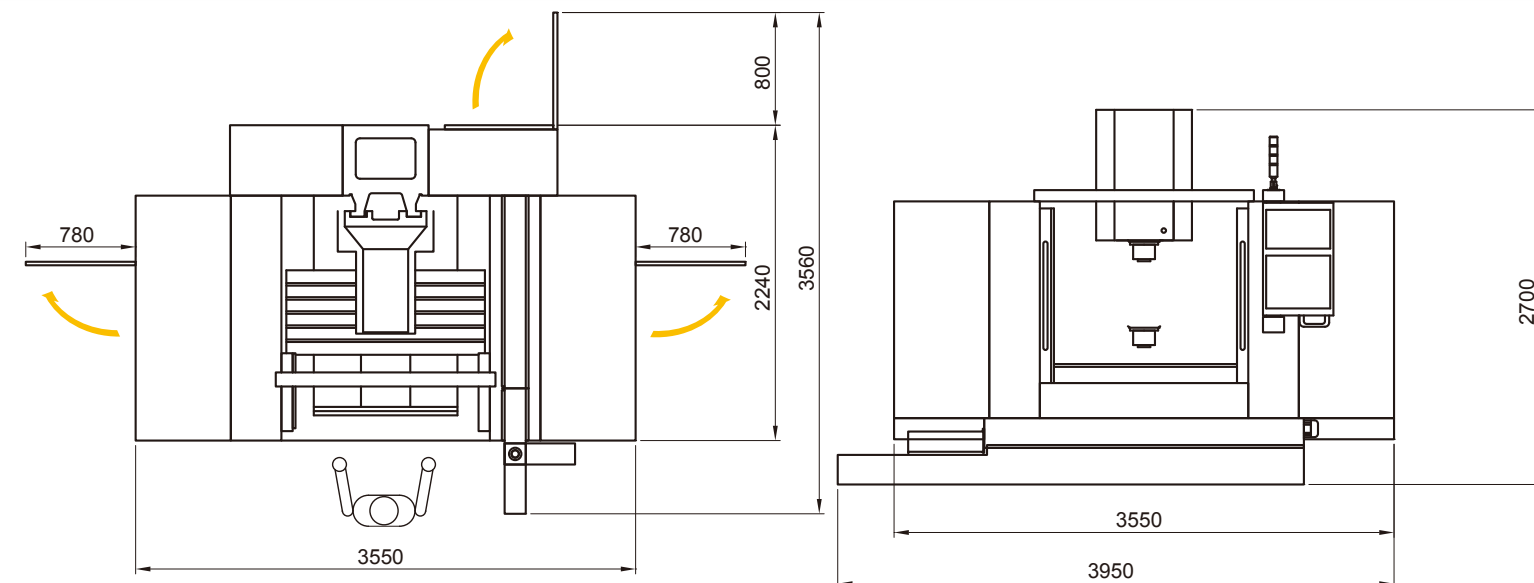



機型	MODEL	VMC-850A	VMC-1000	VMC-1300
X軸行程	X-axis Travel	850mm	1000mm	1300mm
Y軸行程	Y-axis Travel	650mm	600mm	650mm
Z軸行程	Z-axis Travel	610mm	600mm	610mm
工作台尺寸	Table Size	1100x600mm	1100x600mm	1410x600mm
T型槽(寬*個*距)	T-Slots	18x5x100mm	18x5x100mm	18x5x100mm
工作台最大荷重	Max. Table Load	1000kg	900kg	1100kg
主軸鼻端至工作台距離	Spindle nose to table	90~690mm	90~690mm	120~730mm
主軸中心至立柱距離	Spindle center to column	650mm	650mm	680mm
主軸	SPINDLE			
主軸轉速	Spindle Speed	8000rpm	8000rpm 10000rpm & 12000rpm (Opt.)	8000rpm 10000rpm & 12000rpm (opt.)
主軸錐度	Spindle Taper	BT-40	BT-40	BT-40
進給速率	FEEDRATE			
快速位移(X,Y軸)	Rapid Traverse(X.Y)	20m/min	20m/min	15m/min
快速位移(Z軸)	Rapid Traverse(Z)	15m/min	15m/min	12m/min
進給速率(X.Y.Z)	Feed Rate (X.Y.Z)	1-6000mm/min	1-6000mm/min	1-6000mm/min
自動換刀系統	AUTO TOOL CHANGER			
刀具數	Magazine Capacity	24	24	24
換刀方式	Tool Change Type	Arm type	Arm type	Arm type
最大刀徑	Max.tool change diameter	Ø75mm	Ø75mm	Ø75mm
最大刀具重量	Max.tool weight	7kg	7kg	7kg
馬達	MOTOR			
主軸馬達(連續/30分鐘)	Spindle Motor(cont/30min)	AC 11/15kw	AC 11/15kw	AC 11/15kw
軸向馬達	Axise Servo motor	Mitsubishi 3.0kw Fanuc 2.5kw	Mitsubishi 3.0kw Fanuc 2.5kw	Mitsubishi 3.5kw Fanuc 3.0kw
機台淨重	Machine N.W.	6500kg	6350kg	7800kg



Best choice
P-ONE

► Professional ► Innovation ► Insistency

VMC-860L

三軌線性滑軌機構 X,Y,Z Axes Linear Guide Mechanism

- ▶ 寬闊的底座為四滑軌，八個滑塊平均點支撐，確保最佳剛性、精度持久性。
 - ▶ Z軸採用方形滑軌，大幅度提升穩定性與抗震性。
 - ▶ X、Y軸採用精密超重負荷型線性滑軌，確保定位精度、加工誤差的控制。
 - ▶ 機台尺寸精巧設計，充分提高機械空間及效能比。
-
- ▶ 3 axes with linear slide. The best choice of machining center is high speed and high precision.
 - ▶ To ensure the construction of high rigidity of column, base, saddle and head are perfect match for reinforcement of machine rib.
 - ▶ The four slides combined with eight blocks to support the broad base.
 - ▶ To ensure the high rigidity and positioning durability, the construction of X axes is configured & supported by four heavy blocks.



▶ 機械外觀尺寸圖 Machine Overall Dimension

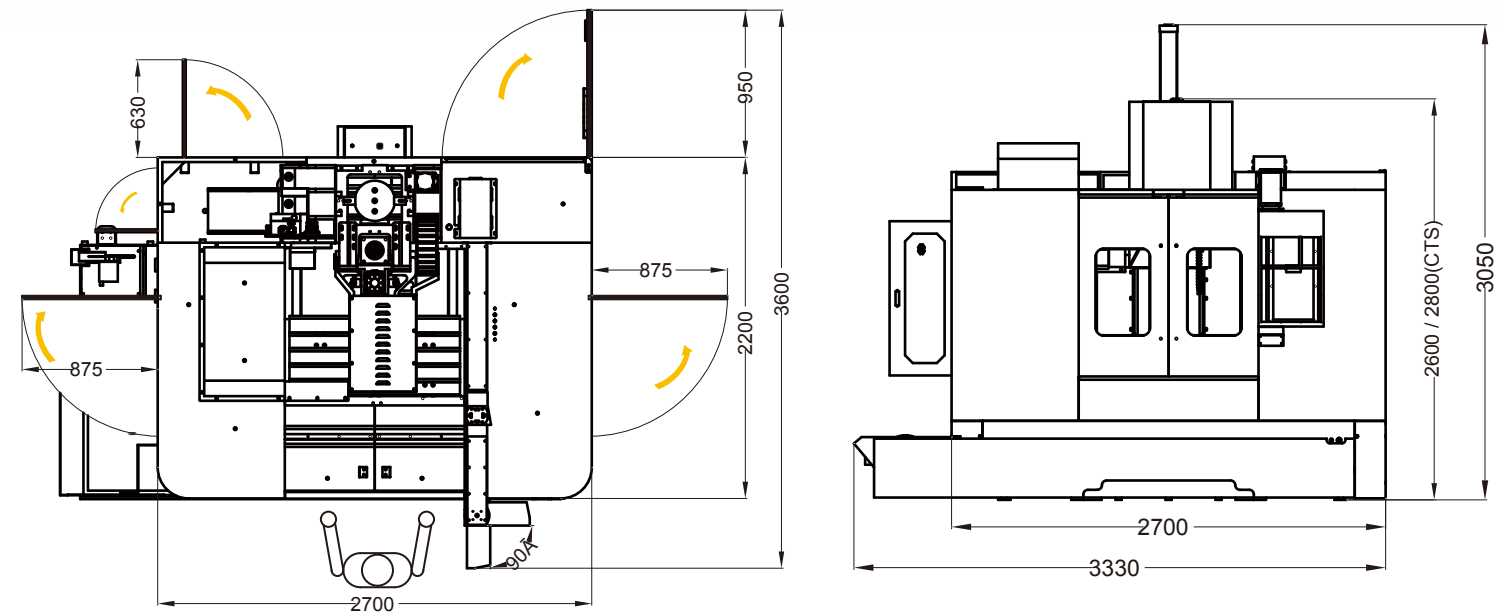



Best choice

P-ONE

► Professional ► Innovation ► Insistency

VMC-1060L

三軌線性滑軌機構 X,Y,Z Axes Linear Guide Mechanism

- ▶ 高速高精度- 加工機械的最佳選擇。
- ▶ 寬闊的底座為四滑軌、八個滑塊平均點支撐。
- ▶ X軸結構以六塊重型滑塊支撐配置，確保最佳剛性、精度持久性。
- ▶ The best choice of machining center is high-speed & high-precision.
- ▶ The four slides combined with eight blocks to support the broad base.
- ▶ The construction of X axes is configured & supported by six heavy blocks to ensure the high rigidity and positioning durability.



▶ 機械外觀尺寸圖 Machine Overall Dimension

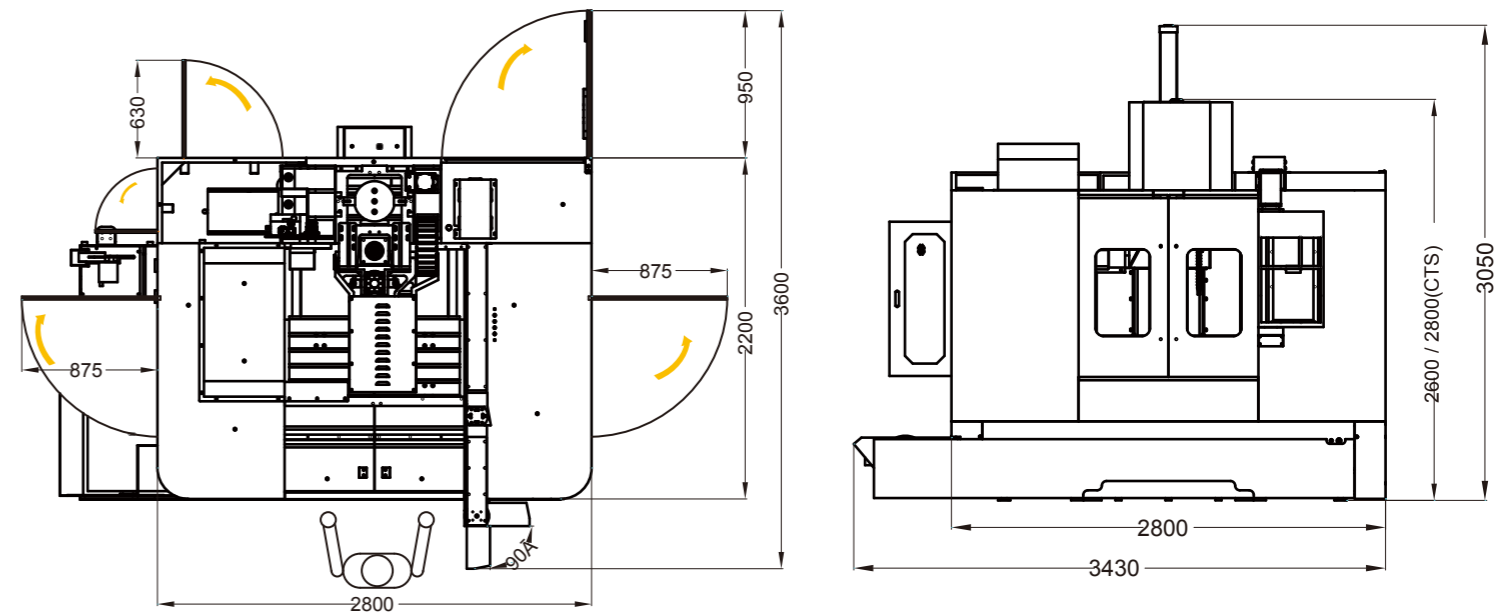



Best choice

P-ONE

► Professional ► Innovation ► Insistency

VMC-1260L

三軌線性滑軌機構

X,Y,Z Axes Linear Guide Mechanism

- ▶ 高速高精度- 加工機械的最佳選擇。
- ▶ 寬闊的底座為四滑軌、八個滑塊平均點支撐。
- ▶ X軸結構以六塊重型滑塊支撐配置，確保最佳剛性、精度持久性。
- ▶ The best choice of machining center is high-speed & high-precision.
- ▶ The four slides combined with eight blocks to support the broad base.
- ▶ The construction of X axes is configured & supported by six heavy blocks to ensure the high rigidity and positioning durability.



▶ 機械外觀尺寸圖 Machine Overall Dimension

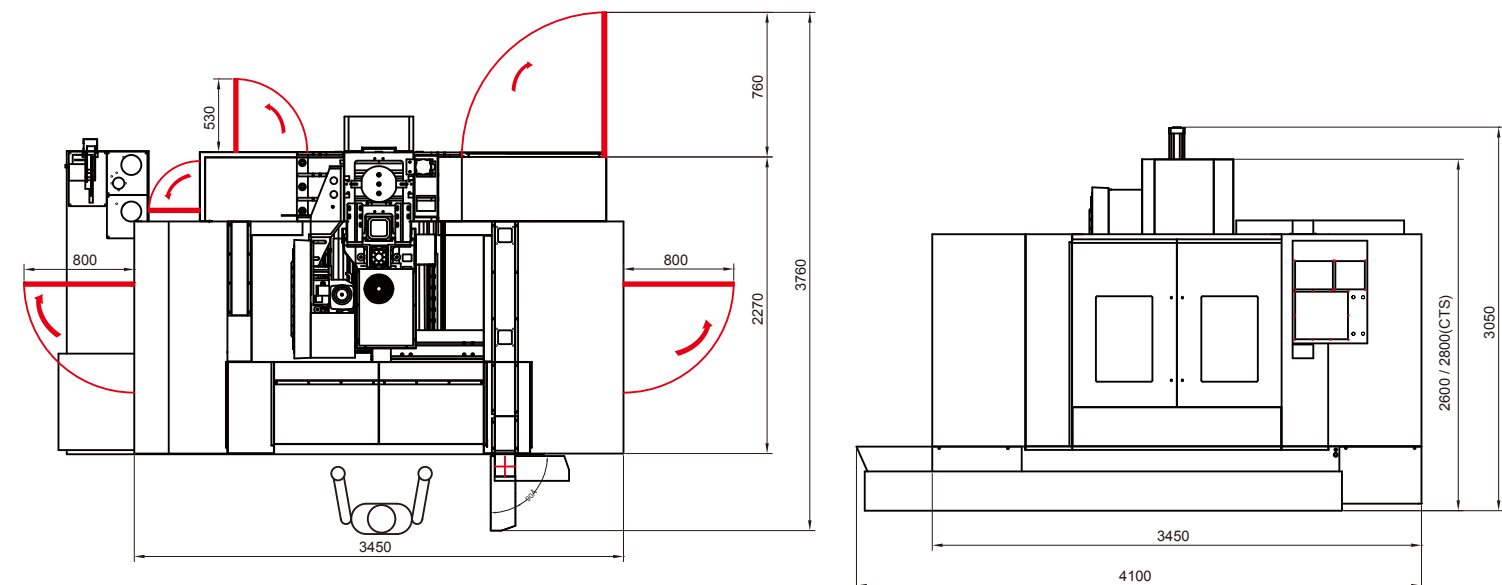



Best choice

P-ONE

Professional Innovation Insistency

機型	MODEL	VMC-860L	VMC-1060L	VMC-1260L
X軸行程	X-axis Travel	860mm	1020mm	1200mm
Y軸行程	Y-axis Travel	580mm	600mm	600mm
Z軸行程	Z-axis Travel	580mm	600mm	610mm
工作台尺寸	Table Size	950x600mm	1100x600mm	1270x600mm
T型槽(寬*個*距)	T-Slots	18x5x100mm	18x5x100mm	18x5x100mm
工作台最大荷重	Max.Table Load	700kg	800kg	1000kg
主軸鼻端至工作台距離	Spindle nose to table	100~680mm	90~690mm	90~690mm
主軸中心至立柱距離	Spindle center to column	650mm	650mm	650mm
主軸 SPINDLE				
主軸轉速	Spindle Speed	10000rpm/ *12000rpm(Opt)	10000rpm / *12000rpm(opt.)	10000rpm (*12000 rpm Opt.)
主軸錐度	Spindle Taper	BT-40	BT-40	BT-40
進給速率 FEEDRATE				
快速位移(X,Y軸)	Rapid Traverse(X.Y)	24m/min	24m/min	24m/min
快速位移(Z軸)	Rapid Traverse(Z)	20m/min	20m/min	20m/min
進給速率(X.Y.Z)	Feed Rate (X.Y.Z)	1-6000mm/min	1-6000mm/min	1-6000mm/min
自動換刀系統 AUTO TOOL CHANGER				
刀具數	Magazine Capacity	24	24	24
換刀方式	Tool Change Type	Arm type	Arm type	Arm type
最大刀徑	Max.tool change diameter	Ø75mm	Ø75mm	Ø75mm
最大刀具重量	Max.tool weight	7kg	7kg	7kg
馬達 MOTOR				
主軸馬達(連續/30分鐘)	Spindle Motor(cont/30min)	AC 7.5/11kw	AC 7.5/11kw	AC 7.5/11kw
軸向馬達	Axise Servo motor	Mitsubishi 3.0kw Fanuc 2.5kw	Mitsubishi 3.0kw Fanuc 2.5kw	Mitsubishi 3.0kw Fanuc 2.5kw
淨重	Machine N.W.	5500kg	6300kg	6900KG

標準配件

三軸伸縮護蓋
全罩式鈹金
脫壓式潤滑系統
捲屑螺桿
冷卻系統
空壓配件三點組合
主軸吹氣裝置
方型護管
調整工具和工具箱
電氣箱熱交換器
水平調整螺栓及墊塊
工作燈
M30 自動斷電功能
RS232/USB/CF 裝置
自動警示燈

Standard accessories

3 axes telescopic cover
Full-enclosed splash guard
3 axes oil lubrication system with press-relief circuit
Screw conveyor
Coolant system
Pneumatic fitting for 3-point built up
Spindle air blast
Square type protective tube
Adjustment tools and toolbox
Heat exchanger for electric cabinet
Leveling pads and bolts
Working light
M30 auto power off
RS232/USB/CF interface
Warning light

選購配件

主軸中心出水
變壓器
蜂鳴器
電控箱冷氣
第四軸旋轉工作台(整組)
第四軸旋轉工作台
(僅含配線油管等組件)
主軸油冷
旋轉視窗
油水分離機
3軸光學尺
刀長量測系統
工件量測系統
鏈條式鐵屑輸送機與集屑車
油霧回收機

Optional accessories

Coolant thru spindle(CTS)
Transformer
Buzzer
Air conditioner for electric cabinet
4th Roatry table & device
4th axis preparation
(wiring only)
Spindle oil cooler
Wash down device
Oil skimmer
Optical scale for 3 axes
Auto tool length measuring device
Auto work piece measurment system
Scraper type chip conveyor + bucket
Oil mist collector
CNC Window Spin